

Precision Duct

6500 Huntley Road • Worthington, OH 43229
Phone (614) 781-0566

Single Wall Round Submittal

Project Name: _____

Engineer: _____

Contractor: _____

Section Number: _____

Date Submitted: _____

Date Approved: _____

Pressure Class:

- 2005 Up to 10" wg
- 1995 2" wg pos
- 1995 4" wg pos
- 1995 10" wg
- 2005 neg WG: _____
- 1995 neg WG: _____
- Underground
- Special Gauge Per Spec

Material Type:

- G60
- G90
- Paint Grip
- Aluminum
- 304L SS
- 316L SS
- 4 x 1 Coated
- 4 x 4 Coated

Connections:

- Couplings
- Gasket 24" max
- Spiral Flange
- Vanstone Angle Ring
- Welded Angle Ring
- Weld Flange
- Raw Butt Weld

Pipe Construction:

- Spiral Lock Seam
- Long Seam Welded
- AcmeLock

Single:

- Single Wall

Grille Boxes:

- 4" Standard
- 4" Std with 1" liner
- 4" Std Double Wall
- 45 deg entry
- 45 deg entry with 1" liner
- 45 deg entry Double Wall

Construction:

- Gore Lock / Spot & Seal
- Continuously Welded

Misc:

- Access Doors at FD
- Reducers at VAV Boxes
- Single Low Pressure Dampers

Installation:

- Installed
- Loose
- Slot Only

Tee / Saddle:

- Full Body Fittings
- Loose Saddle Taps
- Manifold Saddle Taps

Tap Type:

- Straight Taps
- Conical Taps
- Combination Taps
- Lateral Tap

Additional Comments:

Precision Duct

6500 Huntley Road • Worthington, OH 43229
Phone (614) 781-0566

Single Wall Round Submittal

Spiral Pipe

All pipe is fabricated from hot-dipped G90 galvanized steel in gauges that meet or exceed SMACNA standards for spiral ducts. The following chart illustrates approximate weights for spiral pipe. Areas in grey represent fabrication minimum gauges.

Diameter	26 Ga (lbs / ft)	24 Ga (lbs / ft)	22 Ga (lbs / ft)	20 Ga (lbs/ft)
6"	1.6	2.0	2.5	
8"	2.1	2.8	3.3	
10"	2.6	3.4	4.2	
12"	3.2	4.1	5.0	
14"	3.7	4.8	5.8	
16"	4.3	5.5	6.6	
18"	4.9	6.1	7.5	
20"	5.2	6.8	8.3	
22"		7.5	9.1	
24"		8.2	9.9	
26"		8.9	10.8	
28"		9.5	11.6	14.0
30"		10.2	12.4	15.0
32"		10.9	13.3	16.1
34"		11.6	14.1	17.1
36"		12.3	14.9	18.2
38				19.2
40"				20.3
42"				21.3
44"				22.4
46"				23.4
48"				24.5
50"				25.5

SMACNA Gauge Requirements for Round Duct Spiral Seam Unreinforced Positive Pressure*

Max Diameter	+2 W.G.	+4 W.G.	+10 W.G.	Precision Duct
6"	28 Ga	28 Ga	28 Ga	26 Ga
8"	28 Ga	28 Ga	28 Ga	26 Ga
10"	28 Ga	28 Ga	28 Ga	26 Ga
12"	28 Ga	28 Ga	26 Ga	26 Ga
14"	28 Ga	26 Ga	26 Ga	26 Ga
16"	26 Ga	26 Ga	24 Ga	24 Ga
18"	26 Ga	24 Ga	24 Ga	24 Ga
19"-26"	26 Ga	24 Ga	24 Ga	24 Ga
28"-36"	24 Ga	22 Ga	22 Ga	22 Ga
38"-50"	22 Ga	20 Ga	20 Ga	20 Ga
52"-60"	20 Ga	18 Ga	18 Ga	18 Ga

* Source: SMACNA HVAC Duct construction Standards Metal and Flexible – Second Edition 1995

Precision Duct

6500 Huntley Road • Worthington, OH 43229
Phone (614) 781-0566

Single Wall Round Submittal

Connection Types

All fittings are made standard as male size (1/8" smaller) for slip fit into standard spiral ducts except for female coupling, which is made female size equivalent to standard spiral ducts. Fittings come standard unsealed, with sealing available on request. Fittings are fabricated from hot-dipped G90 galvanized steel that meets or exceeds SMACNA standards. Elbows, unless otherwise specified, are fabricated with centerline radius equal to 1-1/2 times the duct diameter. 90° and 45° elbows 5" diameter and smaller are of die-stamped construction. 90° elbows 6" diameter and larger are of 5-piece segmented construction. 45° elbows 6" diameter and larger are of 3-piece segmented construction. Elbow fittings are fabricated with segmented standing seam construction for maximum rigidity, durability, and air-tightness. Fittings are standard fabricated (but not limited to) the following chart:

SMACNA Gauge Requirements for Round Duct Longitudinal Seam Unreinforced Positive Pressure*

Max Diam	+2 W.G.	+4 W.G.	+10 W.G.	Precision Duct
6"	28 Ga	28 Ga	28 Ga	24 Ga
8"	28 Ga	28 Ga	26 Ga	24 Ga
10"	26 Ga	26 Ga	26 Ga	24 Ga
12"	26 Ga	26 Ga	24 Ga	24 Ga
14"	26 Ga	24 Ga	24 Ga	24 Ga
16"	24 Ga	24 Ga	22 Ga	24 Ga
18"	24 Ga	24 Ga	22 Ga	24 Ga
19"-24"	24 Ga	22 Ga	22 Ga	24 Ga
25"-28"	22 Ga	20 Ga	20 Ga	22 Ga
29"-50"	20 Ga	20 Ga	20 Ga	20 Ga

* Source: SMACNA HVAC Duct construction Standards Metal and Flexible – Second Edition 1995

Precision Duct

6500 Huntley Road • Worthington, OH 43229
Phone (614) 781-0566

Single Wall Round Submittal

Connection Types

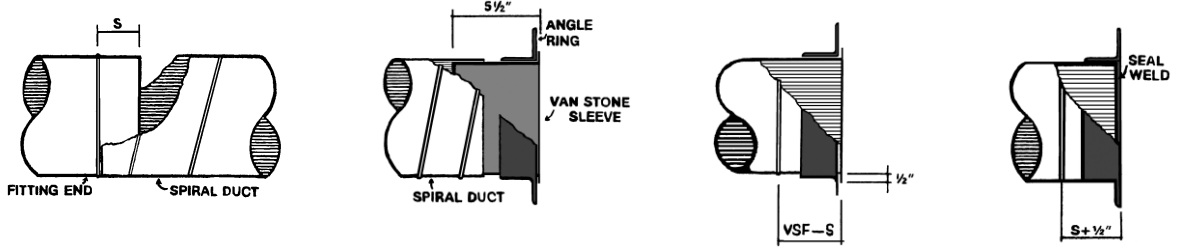

Slip-Fit Connection

Van Stone (Pipe)

Van Stone (Fitting)

Welded Ring

Elbows

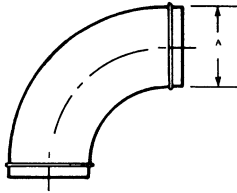

One-Piece Welded 90°

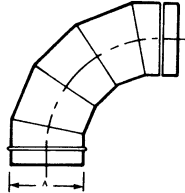

Five-Piece Gored 90°

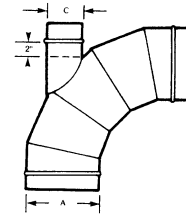

Five-Piece Gored 90°
With Tap

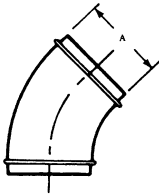

One-Piece Welded 45°

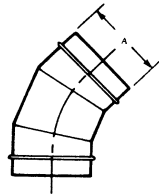

Three-Piece Gored 45°

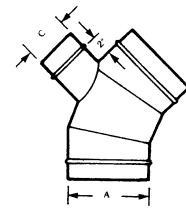

Three-Piece Gored 45°
With Tap

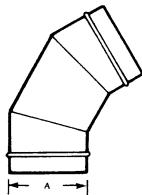

Three-Piece Gored 60°

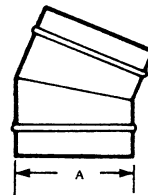

Two-Piece Gored 30°

Centerline Radius = 1.5 x Diameter with 2" Straight After Bead
28" Diam. And Up Come Standard As (2) 45° Elbows With Connector. When Necessary, Specify As One Fitting

Precision Duct

6500 Huntley Road • Worthington, OH 43229
Phone (614) 781-0566

Single Wall Round Submittal

Reducers

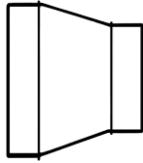

Concentric
Length = Diam Change (minimum 4"), 2" Collars

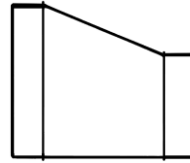

Eccentric
Length = 2 x Diam Change (minimum 4"), 2" Collars

Standard Fitting Type Is Concentric. Specify All Diameters And Changes If Not Concentric.

Tees

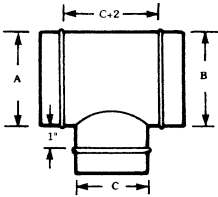

Straight Tee

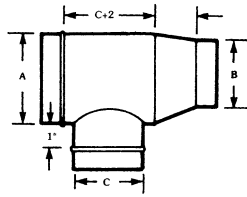

Straight Reducing Tee

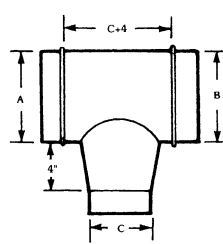

Conical Tee

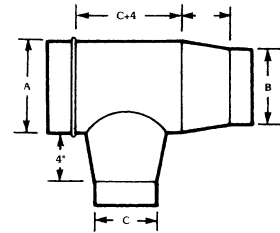

Conical Reducing Tee

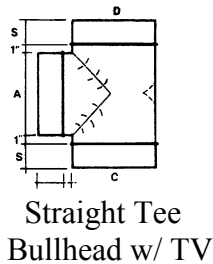

Straight Tee
Bullhead w/ TV

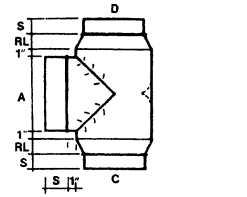

Straight Reducing Tee
Bullhead w/ TV

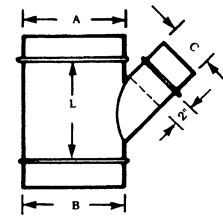

Lateral Tee

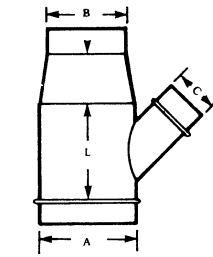

Lateral Reducing Tee

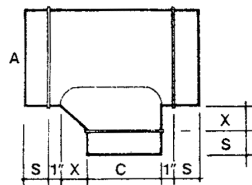

Combination Tee

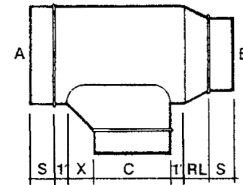

Combination Reducing Tee

Specify All Diameters And Tee Type When Ordering
Branch Roots Are 2" Long, With 2" Collars
Standard Fitting Type Is Straight Tee, With Reducing Coupling (If Necessary)

Precision Duct

6500 Huntley Road • Worthington, OH 43229
Phone (614) 781-0566

Single Wall Round Submittal

Crosses

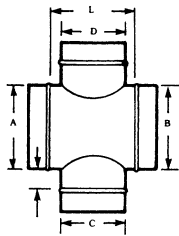

Straight Cross

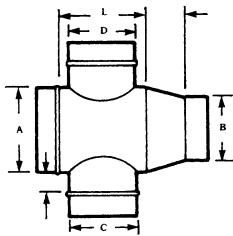

Straight Reducing Cross

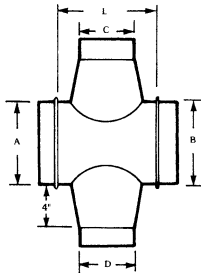

Conical Cross

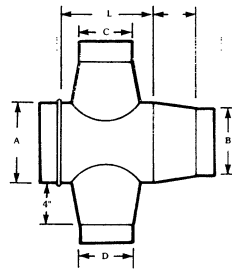

Conical Reducing Cross

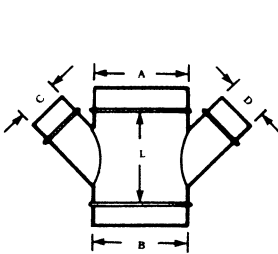

Lateral Cross

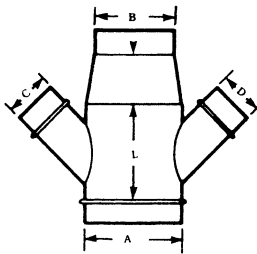

Lateral Reducing Cross

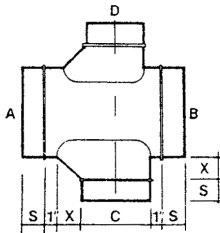

Combination Cross

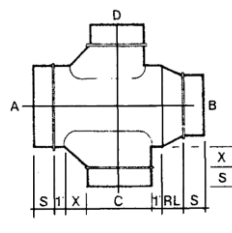

Combination Reducing Cross

Specify All Diameters And Type When Ordering
 Branch Roots Are 2" Long, With 2" Collars
 Standard Fitting Type Is Straight Cross With Reducing Coupling (If Necessary)

Precision Duct

6500 Huntley Road • Worthington, OH 43229
 Phone (614) 781-0566

Single Wall Round Submittal

Round Taps

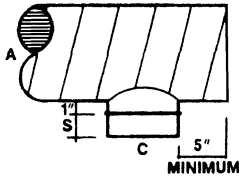

Straight Tap

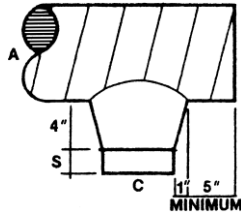

Conical Tap

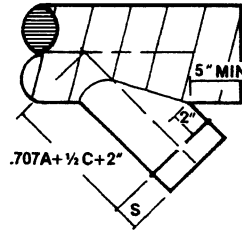

Lateral Tap

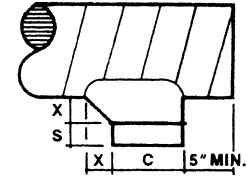

Combination Tap

Specify Type and Diameter When Ordering
 Standard Type is Straight Tap
 Straight Tap Is Precision Spun One-Piece Tap
 Conical, Lateral, and Combination Taps Are Fabricated Saddle-Type With 2" Flange

Rectangular Taps

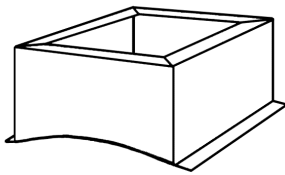

Rectangular Access Tap Without Tabs

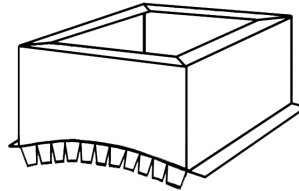

Rectangular Access Tap With Tabs

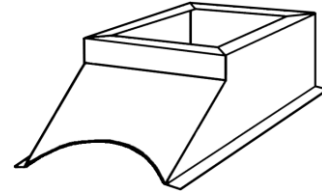

Shoe Access Tap (With or Without Tabs)

Please Specify With or Without Tabs, With Flange In, Flange Out, Or With Slip and Drive Connection
 Standard Fitting Type Is 6" Long Off Pipe, without Tabs, With 1" Flange In (Remember to Upsize From Register Size)

Precision Duct

6500 Huntley Road • Worthington, OH 43229
 Phone (614) 781-0566

Single Wall Round Submittal

Square to Round

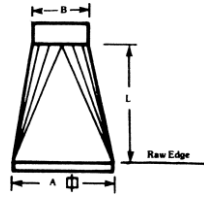

Specify Depth, Width, Length, And Diameter When Ordering
When Not Concentric, Supply Sketch
Length 12" Overall Standard Unless Dimensions Prohibit

Offset

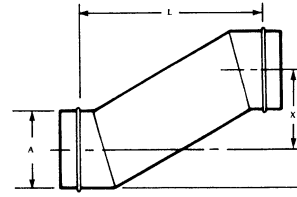

Offset Length = $0.5 \times \text{Diam.} + 2 \times \text{Set}$ (Unless Size Prohibits)
Overall Length = Offset Length + 7" (3.5" Straight), 2" Collars
Specify All Lengths And Diameters When Ordering

Connectors & Caps

Male connector



Female connector



End Cap

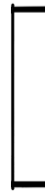

Starting Collar

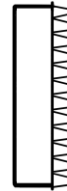

Male Connector	=	Spiral Slip fit, 4" Long
Female Connector	=	Normal Fit, 4.5" Long
End Cap	=	Spiral Slip Fit, 2" Long
Starting Collar	=	Spiral Slip Fit, 2" Long, 1" Tabs

Precision Duct

6500 Huntley Road • Worthington, OH 43229
Phone (614) 781-0566